



Commercial
ECOBREEZE
Air Filtration and Fragrance System

by
WASHROOM WIZARD LTD



Original Installation Guide

Location Guidelines

Please note for best results the following factors have to be taken into account:

- 1) The amount and positioning of airflow. (In and out flow, in flow only, outflow only).
- 2) The number of users/units.
- 3) The size, layout of the location and the odour situation.
- 4) Recommended one Ecobreeze unit in every (3m x 4m room/area).

All these factors can impact the efficiency. For larger areas or particularly odorous, busy locations extra units should be installed.

This appliance is to be used in commercial areas.



Technical Information

Size (l + w +h)	220mmx180mmx62mm
Weight	670 grams.
Power cord	1.8m (2 core DC cable) 500mm (2 core AC cable)
Mains Connected	2 core hard wire (Stripped 10mm)
Power Inlet	85-260 VAC 50-60Hz
Power Adapter	6~13.5VDC
Power Consumption	12W (12V,1A)
Efficiency	>83.5%
Operating Temp:	-10 to +50
Humidity:	95% RH
Polarity Protection	Circuit is protected when VCC & GND are exchanged.
Max Airflow:	up to 24cm
PIR Sensor:	Motion sensor, automatic activation, override switch, fan speed switch, automatic on/off service switch
Installations:	Toilet/Baby change facilities: Permanent with screws-to wall. Corridors: Permanent with screws – to wall. Kitchens & Reception: Permanent with screws to wall. Alternatively in secure/controlled environment on desk/counter.
Certificates:	CE, RoHS, EMC CEC Regulation Level V
Class III Appliance:	Must be used with “SELV” Power supply only - (safety extra low voltage).

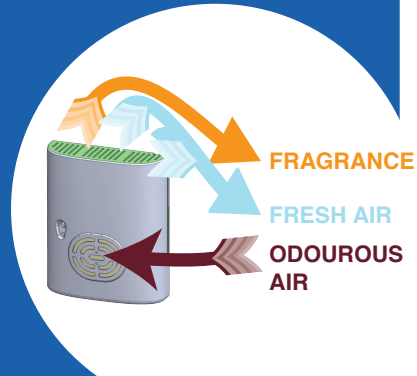
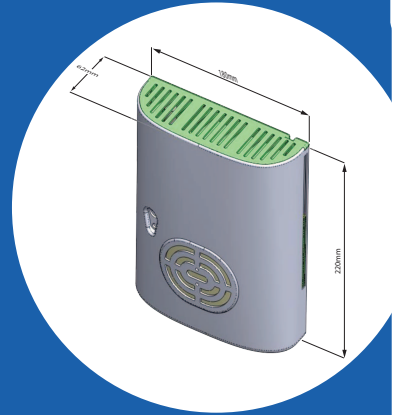

Serial number:..... Model number:.....

IMPORTANT SAFETY INFORMATION

READ CAREFULLY BEFORE ATTEMPTING TO INSTALL OPERATE OR MAINTAIN THE PRODUCT.

Protect yourself and others by observing all safety information.
Failure to comply with instructions could result in personal injury
and/or property damage.

**KEEP THESE SAFETY INSTRUCTIONS IN A CONVENIENT AND
READILY ACCESSIBLE LOCATION.**

General Safety Information

When using electrical appliances, basic precautions should always be followed to reduce the risk of fire, electrical shocks and injury to person, including the following:

- Read all instructions before servicing, cleaning or using Ecobreeze commercial unit
- The unit is intended for commercial use only.
- Use this unit only in the manner intended by the manufacturer. If you have any questions, contact the manufacturer.
- Before servicing or cleaning the unit ensure the power is switched off by the safety switch. This will happen when the front cover drops down.
- The unit must be serviced by a trained or qualified person.
- Only original filters and fragrances supplied by Washroom Wizard LTD shall be used.
- The unit's effectiveness can not be warranted if any other filters or fragrances than the original filters and fragrances supplied by the manufacturer are used.
- The unit is fitted with a locking switch that can be switched between 'constant ON' - 'motion sensor ON'. However there is access to a manual override switch located internally at the base of the unit to 'turn OFF' the device in case of an emergency.
- Do not attempt to service the unit if the fan is still running.
- Only use allocated service key to unlock or lock unit.
- Only use allocated service key to exchange dust filter.
- Ensure the unit is switched off before replacing the filters and fragrances.
- Replace all filters on a regular basis as recommended by the manufacturer.
- If the unit appears to be damaged/vandalised DO NOT attempt to service/clean the unit. The unit must be replaced by the manufacturer, its service agent or similar qualified persons in order to avoid a hazard.
- Regular cleaning of the outside of the unit is recommended using a soft cloth, never use strong solvents to clean the unit.
- Do not immerse unit or any working part in water or other liquid.
- Read service guide prior to servicing and follow instructions carefully as recommended by manufacturer.
- If the installation and/or maintenance and servicing is to be completed by persons which the manufacturer has no control or the authorized representative or maintenance persons language is other than English, and if these instructions are required to be translated in the correct language it is the responsibility of the agent, distributor or authorized representative. Washroom Wizard LTD will not take liability if any such translation of original documentation occurs.
- This appliance can be used by children aged from 8 years and above and persons with reduced physical, sensory or mental capabilities or lack of experience and knowledge if they have been given supervision or instruction concerning use of the appliance in a safe way and understand the hazards involved. Children shall not play with the appliance. Cleaning and user maintenance shall not be made by children without supervision.

ARROWS INDICATE AIR FLOW

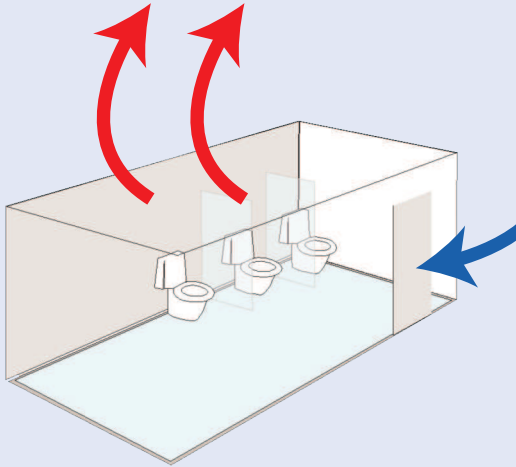

The following guidelines will help you choose the optimum location for the Ecobreeze unit.

- Ecobreeze units operate most efficiently when installed away from outgoing (out flow) air vents.
- If there is a strong airflow in the facility the unit should be fitted close to main odour source and yet furthest away from extraction or air outlet.
- Ideal location is close to the main source of the odour (near toilet or urinal).
- Male toilets - units must be installed directly above urinal for optimum efficiency.
- Female toilets - units must be install near WC and close to entrance door.
- Disabled Toilet/Baby change - unit must be installed above nappy bin.
- For optimal height top screw hole height is 2 meters from floor.
- Wall mounted with appropriate screws is recommended in public washrooms to reduce the risk of vandalism.

Please note below are only suggested electrical installation instructions. The unit is provided with hardwire extension and a qualified person should connect all electrical wiring. Washroom Wizard Ltd takes no responsibility for incorrect electrical installation or under qualified persons connecting the electrical wiring.

Once the unit is mounted/fixed to the wall follow the basic electrical instructions below. Any further queries relating to the instructions or general operating issues contact Washroom Wizard Ltd.

4 Common electrical installation situations:

1. A false ceiling installation. (Where the two core low voltage cable is fed through the false ceiling).
2. An existing spur installation. (Where there is an existing spur present below ceiling).
3. An area where there are no false ceilings, or existing spur points and only permanent walls.
4. An area with dry wall/stud walls and no existing spur points.

4 Suggested electrical installation situations:

1. Fix unit as per instructions to wall with screws and screw plugs. Feed two core low voltage cable behind the unit and through the ceiling via transformer to closest electrical point. (Cable guide found on back plate of unit).
2. As per installation (no.1) feed cable wire through ceiling, fixing the transformer box in ceiling. Feed extension back through ceiling and connect to existing spur.
3. Electrician to install spur as to regulations, hardwire AC to spur and securely mount transformer with suitable safety cover.
4. Feed transformer through dry wall and run cable to closest electrical point. Ensure transformer is firmly secured in place.



STEP 1



Push service key into bottom of unit, front cover slides down

Service keys access

During transport all units are in the locked/closed position. To open insert service key at bottom of unit as illustrated.

STEP 2

Cable Guide

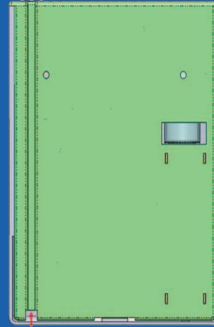

Cable guide on back plate

For electrical connection in ceiling or spur near ceiling, tuck cable into cable guide and feed it through. This will ensure a flush wall fitting.

STEP 3

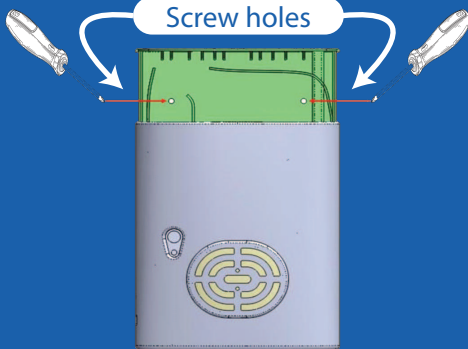

Screw holes

Mount the back plate of the unit to the selected location. Ensure you use the correct wall plugs and fixings for the wall material to secure the unit. For ideal positioning for best air circulation and accessibility mount the unit 2 meters (top screw hole positioning) from floor.

STEP 4



Red button override switch

Black slide switch for fan speed

Safety ON/OFF Switch (Internally)

Once unit is fixed to the wall select appropriate setting for room. (according to room size, odorous environment, location, etc).

Service Guide

Recommended Service Cycle:



- 24 hour locations: every 6 weeks (high to medium fan speed)
- Odorous and limited airflow every 6 weeks (high fan speed)
- Medium to small areas and/or few odours every 8 weeks (medium to low fan speed).
- It is not recommended to keep the carbon filter and fragrance in unit for longer than 8 weeks without a full exchange.

STEP 1

Once unit is unlocked, front cover drops / slides down.

Service key access

STEP 2a

Fragrance bottle chamber

Carbon Filter chamber

Remove cap from fragrance bottle all outer packaging from carbon filter. Place inside allocated areas

STEP 2b

Fragrance bottle

Carbon filter

Slide front cover up to close unit.

Final step...

Insert service key in front filter holder and pull front filter holder out.

Remove dust filter and replace with clean filter

SAFETY ON/OFF Switch

NOTE: After placing fragrance bottle and carbon in chamber, please ensure front cover is firmly closed before replacing front dust filter.

Washroom Wizard Ltd cannot guarantee performance if unit is not serviced on a regular basis as per service instructions (Please contact Washroom Wizard Ltd for any further advice or recommendations with regards to replacements and refills)

CONTACT: 020 7788 7702
or your local service provider.



Recommended Disposal of Consumables:

Carbon filters

Dispose of used filters in general waste.

Fragrance bottle

Dispose of in appropriate recycle waste.

Serial number:..... Model number.....

**IMPORTANT SAFETY INFORMATION
READ CAREFULLY BEFORE ATTEMPTING TO INSTALL
OPERATE OR ELECTRICAL MAINTAIN THE PRODUCT.**

Protect yourself and others by observing all safety information.
Failure to comply with instructions could result in personal injury
and/or property damage

**KEEP THESE SAFETY INSTRUCTIONS IN A CONVENIENT AND
READILY ACCESSIBLE LOCATION.**

Warning General Safety Information

When using electrical appliances, basic precautions should always be followed to reduce the risk of fire, electrical shocks and injury to person, including the following:

- Read all instructions before installing or using Ecobreeze commercial unit
- The unit is intended for commercial use only.
- Use this unit only in the manner intended by the manufacturer. If you have any questions, contact the manufacturer.
- According to wiring regulations (BS7671) and appropriate statutory regulations, it is essential that the power source is disconnected and isolated, prior to installation or any maintenance.
- The unit must be connected to a double pole, fused, switched connection unit (FCU) having a contact separation of at least 3mm in all poles and fitted with a 3amp fuse. This must be sited outside a room containing a fixed bath or shower.(Recommended site where applicable: is in ceiling above ceiling board(s) or into existing spur that is located in room close to ceiling whereby transformer box can be fixed above ceiling board /outside room).
- A means for disconnection must be incorporated in the fixed wiring in accordance with the wiring rules.
- Ensure that mains supply (Voltage, Frequency and Phase) complies with the rating label.
- The unit should only be used in conjunction with fixed wiring.
- The unit should not be used where it is liable to be subject to direct water spray.
- Installation work and electrical wiring must be completed by a qualified person(s) in accordance with all applicable codes and standards including fire related instruction.
- The appliance is not intended to be installed, used or maintained by young children or infirm persons with out supervision.
- If the cord is damaged it must be replaced by the manufacturer or its service agent or similar qualified persons to avoid a hazard.
- The location of the unit is important both for the safe operation and for the efficient extraction and replacement of air within a room.
- For best results the unit should be mounted/ fixed approximately 400mm from the ceiling and as far away as possible from main source of air replacement in the room.
- If the installation and/or maintenance is to be completed by persons which the manufacturer has no control or the authorized representative or maintenance persons language is other than English, and if these instructions are required to be translated in the correct language it is the responsibility of the agent or distributor. Washroom Wizard LTD will not take liability if any such translation of original documentation occurs.

- For busy odourous locations fan can be set either to full or medium speed.
- For less busy or less odourous locations fan can be set to medium speed.
- For small less odorous locations fan can be set to medium/low speed.
- For reception areas or office area's fan can be set to medium/low speed.
- For optimal height top screw holes should be positioned 2 meters from floor.
- Male toilets- units must be installed directly above urinal for optimum efficiency.
- Female toilets - units must be installed near WC and close to entrance door.
- Disabled-use Toilet/Baby change - unit must be installed above nappy bin.

It is recommended that in public lavatory facilities the fan should be on constantly. (Override button pressed in and fan on full speed).

For reception areas, corridors or mainly odourless areas the fan should be on low speed.

(Please contact Washroom Wizard Ltd for any further information with regards to functions or installation. In the unlikely event that the odorous situation has not improved after 14 days of installation please contact Washroom Wizard Ltd for further information and assistance).

Please note: Once unit is installed and activated ensure fragrance bottle without lid is placed in fragrance chamber and carbon filter is placed in carbon chamber. Inform service engineer / cleaning manager that unit has been installed and activated.

CONTACT: 020 7788 7702
EMAIL: info@ecobreeze.com
www.ecobreeze.com
or your local service provider.

